



WE ARE EXCITED TO LET YOU KNOW ABOUT  
THE NEW CHURCH AND COMMUNITY CENTRE  
WE ARE BUILDING ON MONCKTONS LANE

St  
FAITH'S  
CENTRE

“ Oh! How fabulous. It’s been a long time coming!” A LOCAL RESIDENT

## OUR VISION

St Faith’s Centre will be a modern, bright, accessible and safe environment where all are welcomed and treated with dignity. At the very heart of St Faith’s Church is the desire to love God and to love our neighbours. Ringlestone and Springfield are in the parish of St Faith’s, Maidstone, in the Diocese of Canterbury. The centre is designed to be multipurpose, so it will also be the local Anglican Church, replacing the existing St Faith’s church building in the centre of Maidstone which is being sold to another church organization to make this project possible.

The original St Faith’s Hall was founded in 1935 to meet the spiritual, educational, physical and social needs of the local residents. Since then it has been continually used and is now the only community facility in the area.

## MORE COMMUNITY ACTIVITIES & SERVICES

The local Ringlestone community has been welcomed, received support and had much enjoyment here, but the building is no longer fit for purpose and needs replacing. With a brand new and enlarged centre we will continue the legacy of the local people who gave the land and founded the current Hall. This will increase the capacity for mother and baby groups, children’s activities, music, dance, drama, keep fit, support groups, quizzes, variety shows and church activities and services. Both the existing community and those in the new communities being developed close by will all be able to use the centre.



THE EXISTING RINGLESTONE HALL

## HISTORY

- 1872 St Faith’s Church, Brenchley Gardens, dedicated
- 1935 St Faith’s Church Hall in Ringlestone opened
- 2013 Ringlestone Community Centre Development Group (RCCDG) set up as a charity, bringing the church and community together to work towards establishing a new church and community centre
- 2017 Maidstone Borough Council commissioned a study which confirmed the need for a new community centre in this area
- 2019 St Faith’s Church and RCCDG commissioned Hawkes Architecture to draw up plans
- 2020 Planning permission for the new St Faith’s Centre granted

## WHAT'S INSIDE?

A light and airy main entrance welcomes you into the central meeting area which connects the main hall and smaller resource rooms.

### CAFE FACILITIES

There will be a generous kitchen with servery.

### THE MAIN HALL

can accommodate 120 people seated and plenty of space for all the variety of community needs.



The new building will provide much-needed space for all the local community to enjoy and a vibrant place for the church community to worship.

**“...this is a high quality scheme that will make a significant contribution to the local community.”**

PLANNING OFFICER, MAIDSTONE BOROUGH COUNCIL



### THE SMALL HALL

is designed to accommodate a nursery or day-care facility, complete with its own secure access and separable toilets.

### UPSTAIRS

there are five more multipurpose resource and meeting rooms with lift access and small kitchen.

### GARDEN

The inside flows naturally out into the garden a tranquil space for meeting and sharing.

### GROUND FLOOR PLAN

1. Foyer & Café
2. Main hall (175m<sup>2</sup>)
3. Small hall (65m<sup>2</sup> divisible)
4. WC / disabled / baby change
5. Kitchen
6. Lift & stairs
7. Parking (14 cars)
8. Bicycle parking
9. Garden

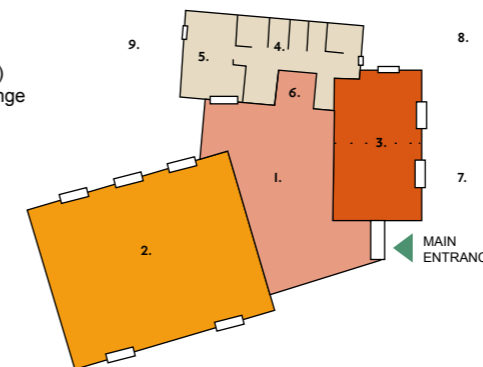

### FIRST FLOOR PLAN

10. Double height entrance hall
11. Double height main hall
12. Communal space
13. WC/ disabled / baby change
14. Resource room (64m<sup>2</sup> divisible)
15. Multipurpose meeting rooms

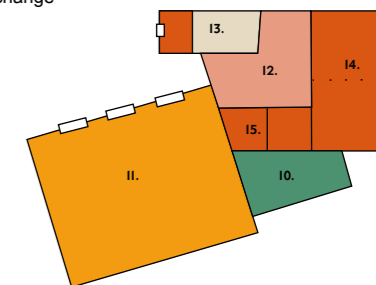



“Absolutely amazing!”

A LOCAL RESIDENT

## WHO WILL MANAGE THE PROJECT?

A team from St. Faith's Church and the Ringlestone Community Centre Development Group is leading the development. The building has been designed with particular attention to

### SUSTAINABILITY AND POSITIVE ENVIRONMENTAL IMPACT

Once funds are in place we can issue tenders and demolish the old hall and vicarage next door. We aim to begin building in early 2021 and open the doors in summer 2022. Although some disruption to existing users is unavoidable, the majority of groups are looking forward to returning when the new centre opens.

We will employ key staff and draw on a large pool of volunteers to help run the centre. Running costs will be met from lettings income, voluntary donations and some grants, overseen by a joint management committee.

## HOW MUCH WILL IT COST?

Following a detailed analysis of construction costs from a local builder, site analysis for the foundations, demolition, professional fees and contingencies, and fitting out the building the expected cost is: £1,600,000

## HOW WILL IT BE FUNDED?

We are encouraged to have raised 45% of the cost through sale of buildings and reserves. We are applying for developer contributions (S.106 funds) through Maidstone Borough Council and for grants from Foundations and Trusts. We will need to raise £150,000 from the church congregation, community and our wider network of friends.

## THANK YOU!

The information in this brochure has been produced by St Faith's Church, Maidstone and the Ringlestone Community Centre Development Group.

# WE NEED YOUR HELP

Every contribution big or small will help.

There are three ways you can help:

**Money** – a financial gift will be a huge help

**Time** – if you have a trade you could help us during the build

**Ideas** – fundraising events will make a difference

Please see the enclosed response form.

“This centre, at the heart of our communities, is for all our neighbours and friends and for future generations to come.” RCCDG TRUSTEE

## WANT TO KNOW MORE?

[st-faiths.org.uk](http://st-faiths.org.uk)

Facebook: **Ringlestone Community Centre Development Group**

The full planning application can be found online through Maidstone Borough Council's Public Access Portal ([pa.midkent.gov.uk/online-applications](http://pa.midkent.gov.uk/online-applications)) **ref.: 20/500605/FULL**

If you would like more information or to offer support please contact:

St Faith's Church  
St Faiths Street  
Maidstone  
ME14 1LH

Rev. Canon Arthur Houston  
Priest-in-charge  
01622 858020  
[info@st-faiths.org.uk](mailto:info@st-faiths.org.uk)

Rose Henn-Macrae  
Chair, RCCDG  
01634 669394

Donate via [www.justgiving.com](http://www.justgiving.com) - search for: **St Faith's Centre**

St  
FAITH'S  
CENTRE